

CANTILEVER LOAD CELL – MODEL : EP-616-CD

Features :

- Low Profile.
- Minimum Error for Off-Centre loading.
- Small Size.



Applications :

- Small Sized Platform Scales.

SPECIFICATIONS

Rated Capacity	300, 500, 750, 1000 Gms		
Excitation Voltage	3 - 10 V DC	Insulation Resistance (50 V DC)	1000 M Ohms
Nominal Output	0.7 to 1.0 m V/V	Cable Length	100 mm
Non - Linearity	± 0.05 % FSO	Safe Overload	120 %
Hysteresis	± 0.05 % FSO	Ultimate Overload	150 %
Non-Repeatability	± 0.02 % FSO	Temp. Compensated Range	0 - 45 °C
Creep (30 minutes)	± 0.05 % FSO	Temperature Effect on Output	0.0015% FSO/°C
Zero Balance	± 1.0 % FSO	Temperature Effect on Zero	0.0020% FSO/°C
Input Resistance	1000 ± 10 Ohms	Deflection	0.5 mm at FSO
Output Resistance	1000 ± 3 Ohms	Protection Class	IP65

Dimensions :

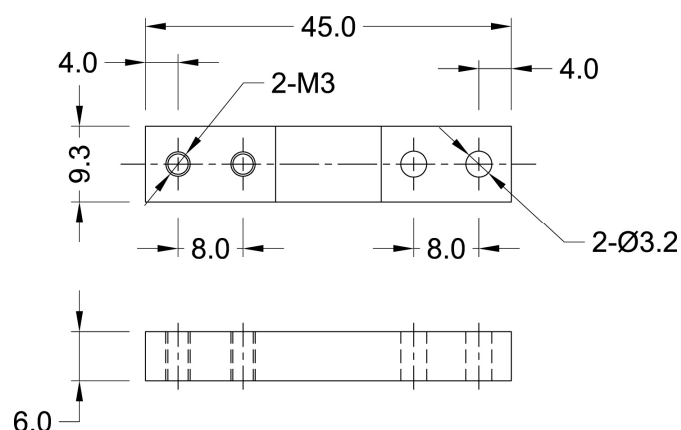

EPOCH

Instruments & Controls Pvt. Ltd.

Office : F#1, Paradise Apartments, No. 11, 1st Floor, 5th Cross, Prashanthnagar, Bangalore – 560 079.

: ☎ : 080 – 2348 1364, 6576 1259. ☎ : 080 – 2328 3728. E-mail : epochic@dataone.in.

Factory : No. 16, Bhadrappa Estae, 54, Magadi Main Road, Kamakshipalya, Bangalore – 560 079. ☎ : 080 – 2328 7998.

Branch : No. 409, Kemp Plaza, B-Wing, Opp. Mind Space, Chincholi Bunder, Malad (West), Mumbai – 400 064.

: ☎ : 022 – 4003 0704, 4003 0705, 4003 0706. ☎ : 022 – 4003 0707. E-mail : synapsis@vsnl.com.